

INSTALAR IPTV NO IPHONE – IOS – GSE IPTV

1. Baixe e instale o App: GSE IPTV na Play store.

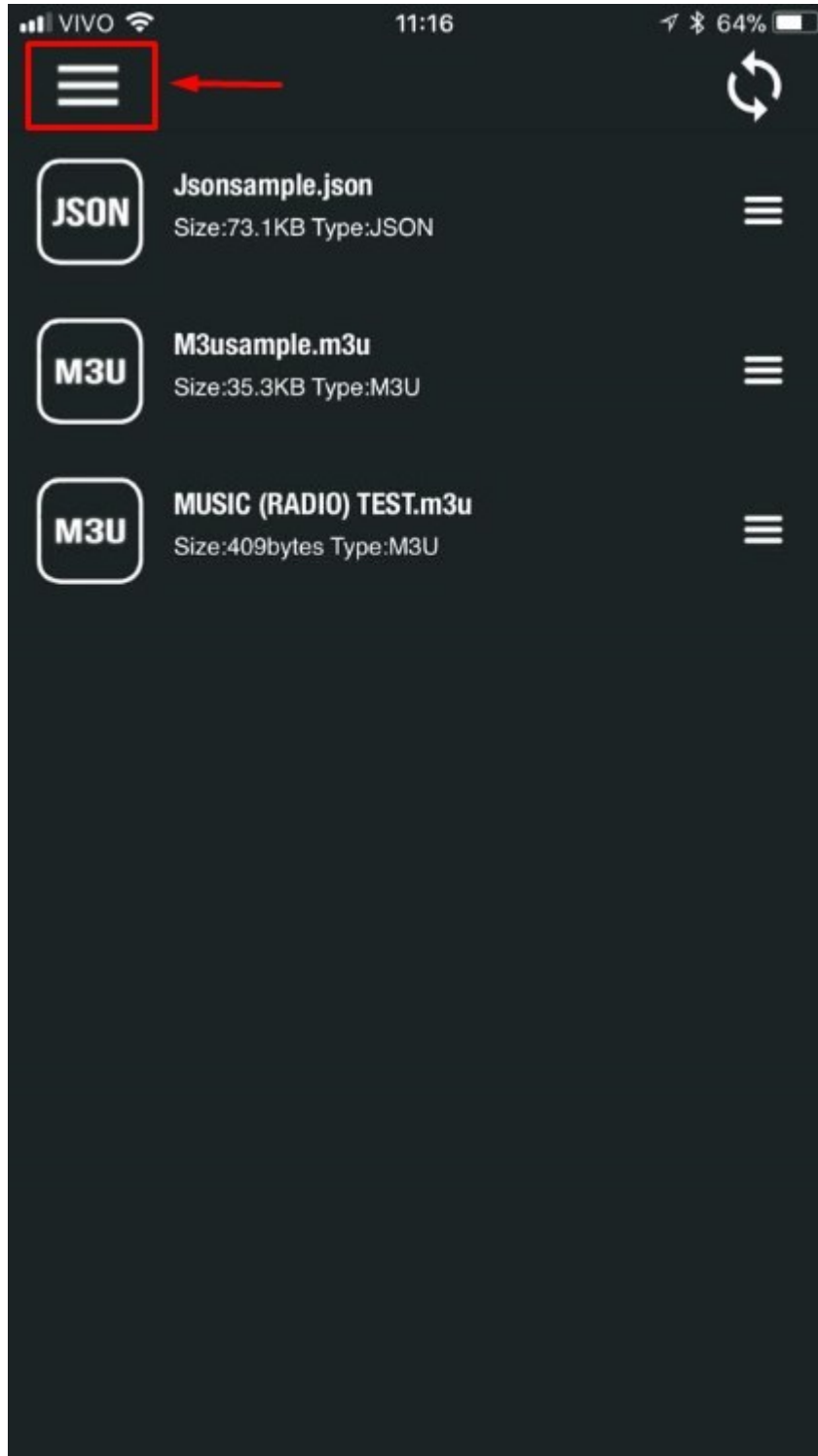

2. Abra o aplicativo e clique no menu, conforme a imagem abaixo:



3. Em seguida selecione a opção: Remote playlists

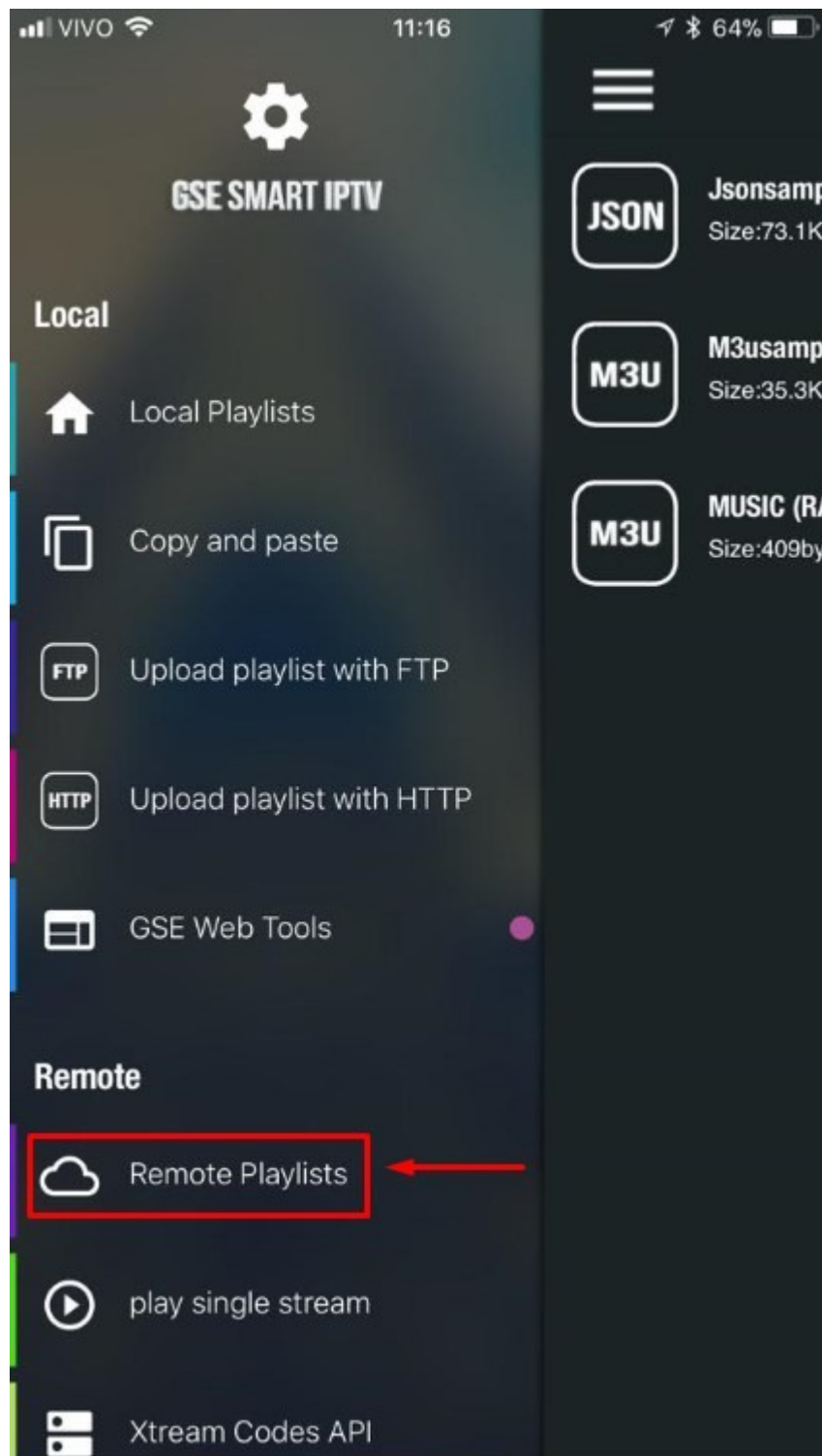

4. Agora clique no +, para adicionar a sua lista, e em seguida selecione a opção: Add M3U URL.

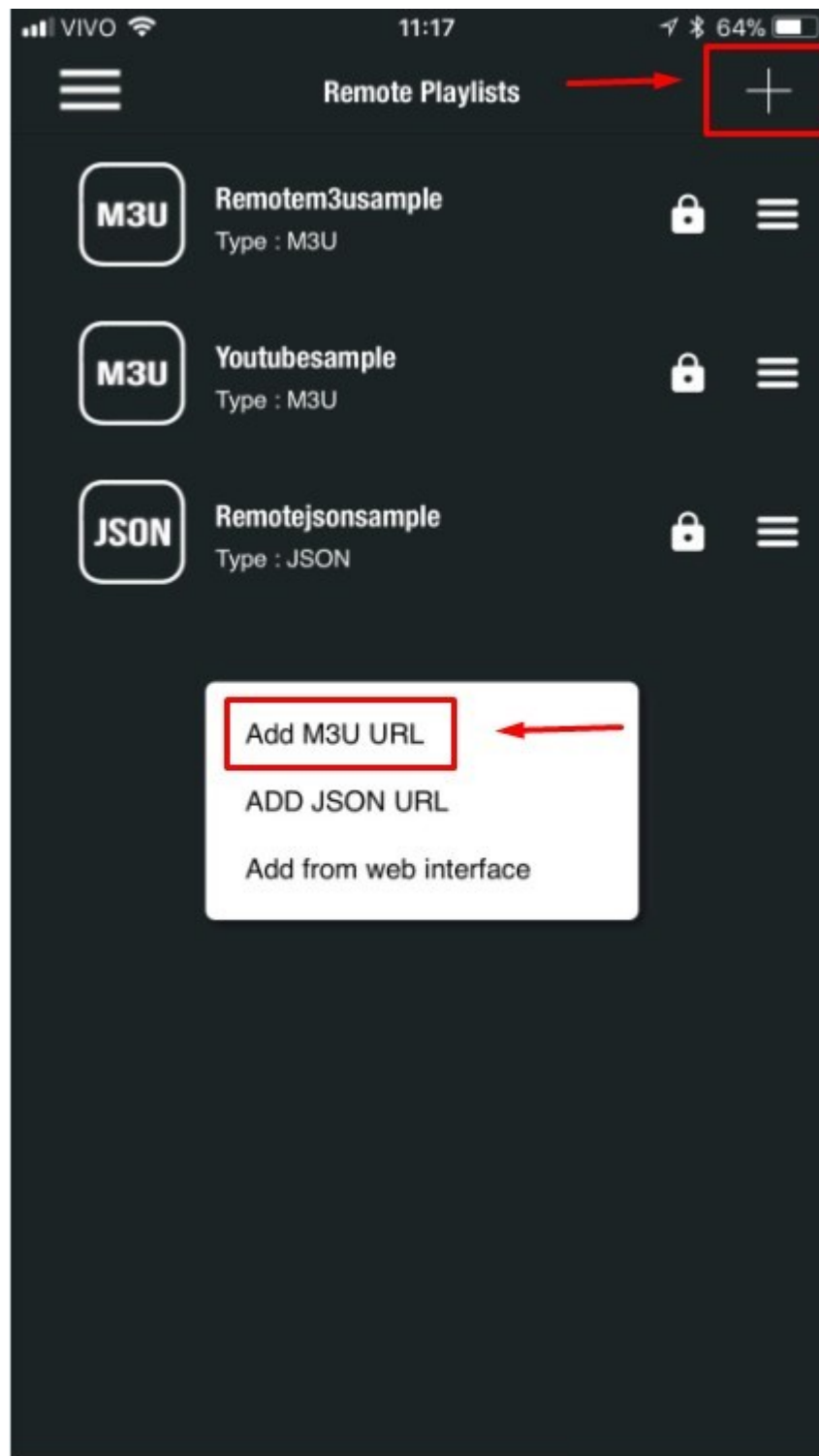

5. Agora na opção playlist name adicione um nome para a sua lista, e em playlist link adicione o link da sua lista de canais e clique em Add.

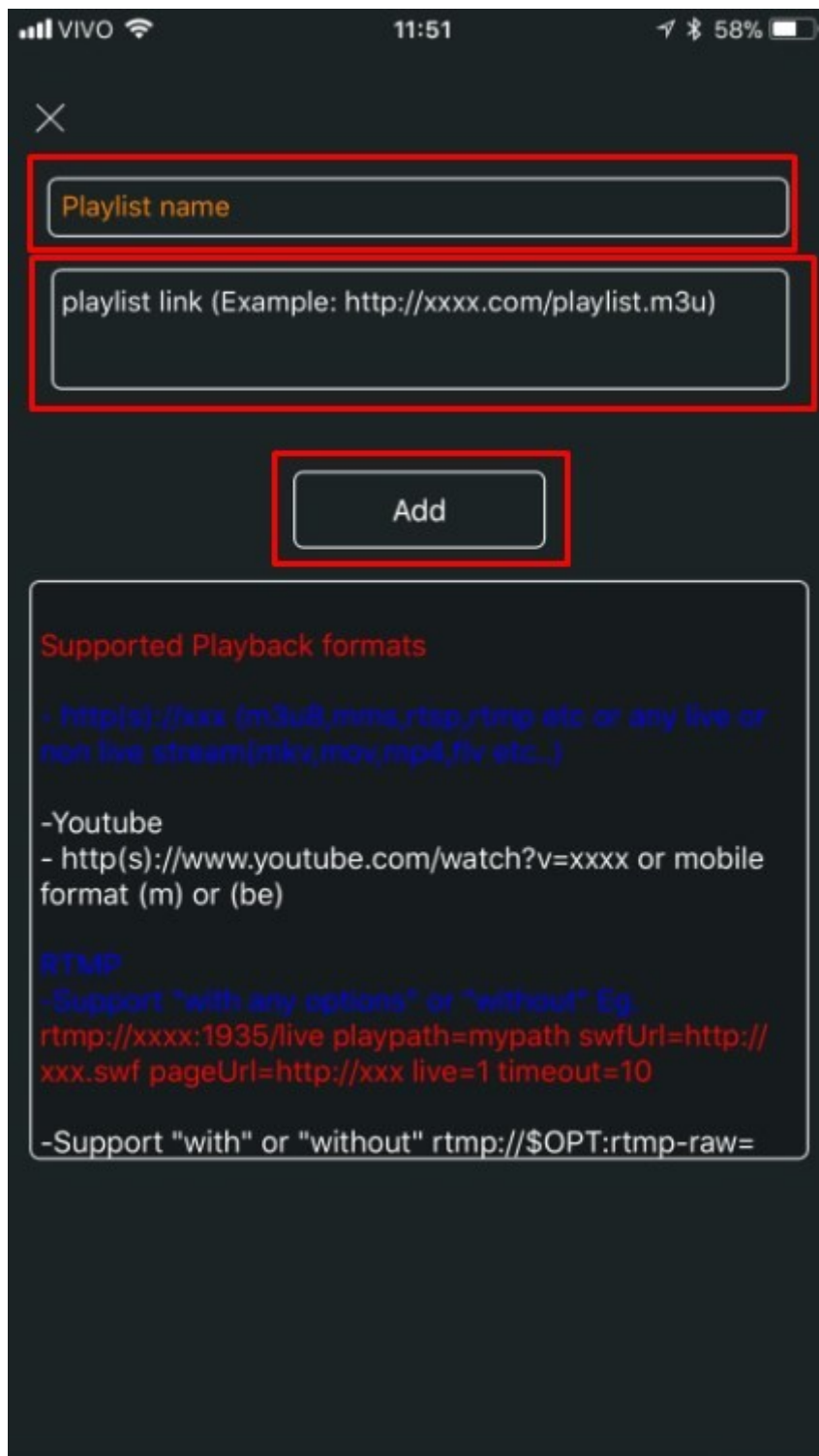

6. Acesse novamente a opção no menu: Remote Playlist e irá aparecer a playlist que você criou, selecione e irá aparecer a lista de canais.

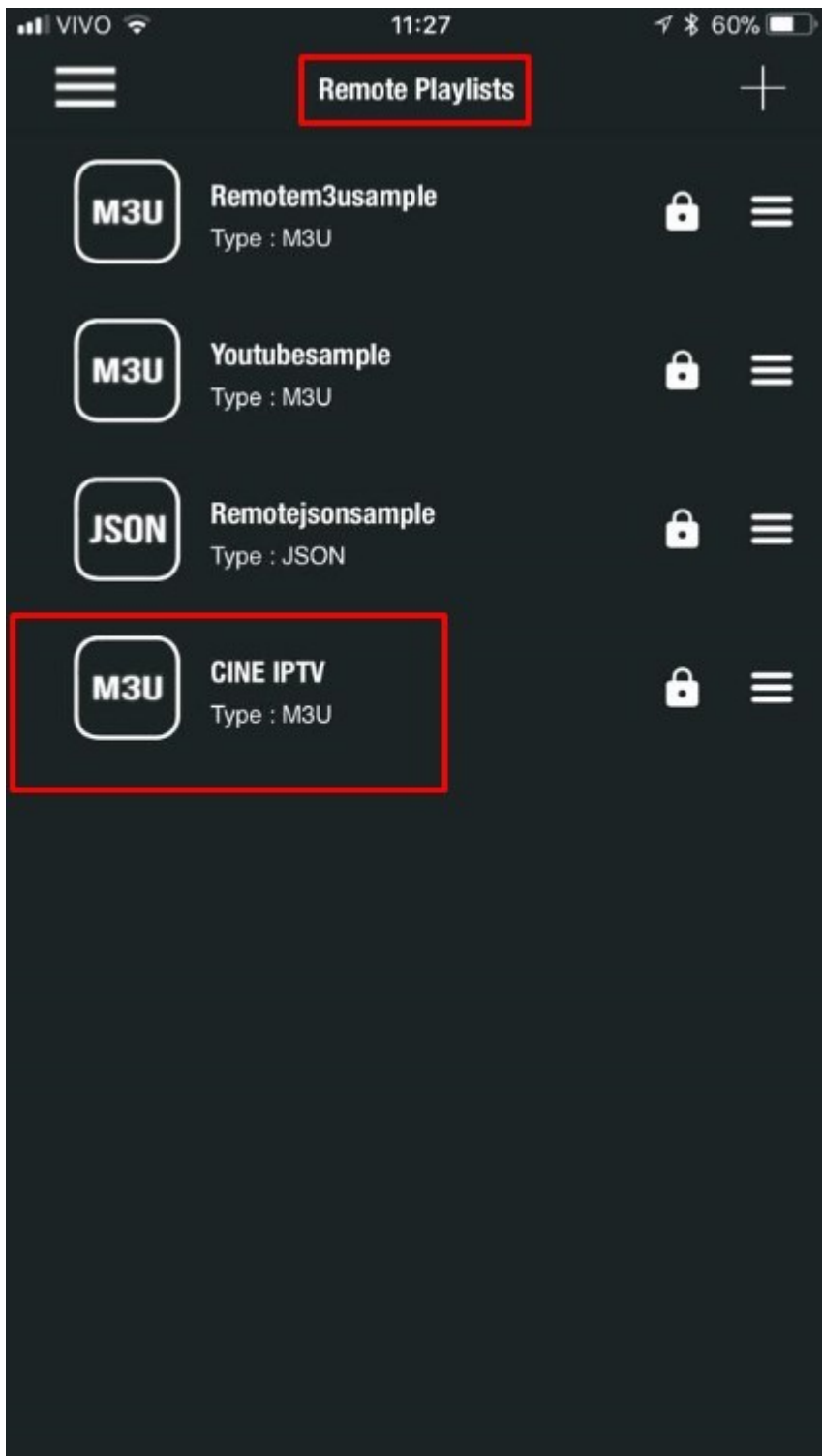

7. Bom entretenimento.

The screenshot shows the 'CINE IPTV' app interface on a mobile device. At the top, the status bar displays 'VIVO', signal strength, Wi-Fi, the time '12:06', and a battery level of '56%'. Below the status bar, there is a navigation bar with a back arrow, a star icon, and the text 'CINE IPTV'. The main content area is a list of channel groups, each represented by a television icon, the group name, and a red number indicating the count of channels. The groups listed are: 'All channels group' (847), 'Ação' (85), 'Animação' (68), 'Aventura' (25), 'Canais Abertos' (23), 'Canais Globosat' (15), and 'Canais HBO' (25). At the bottom of the screen, there is a banner for the app, featuring the Spotify logo, the text 'Aplicativo Grátis', the 'App Store' logo, and a white button labeled 'INSTALAR'.

Channel Group	Count
All channels group	847
Ação	85
Animação	68
Aventura	25
Canais Abertos	23
Canais Globosat	15
Canais HBO	25